

Factory Radio Removal

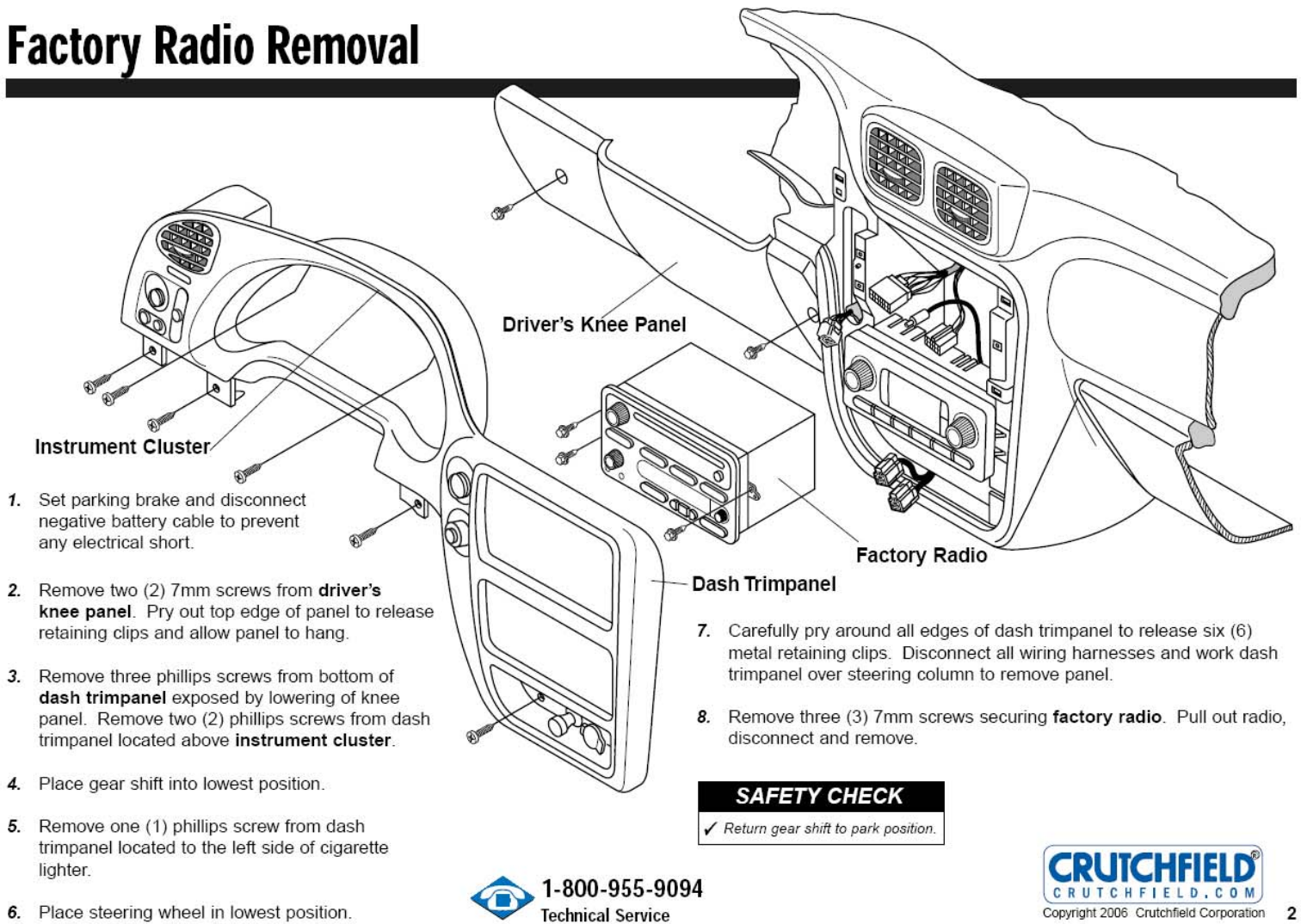

1. Set parking brake and disconnect negative battery cable to prevent any electrical short.

2. Remove two (2) 7mm screws from **driver's knee panel**. Pry out top edge of panel to release retaining clips and allow panel to hang.

3. Remove three phillips screws from bottom of **dash trimpanel** exposed by lowering of knee panel. Remove two (2) phillips screws from dash trimpanel located above **instrument cluster**.

4. Place gear shift into lowest position.

5. Remove one (1) phillips screw from dash trimpanel located to the left side of cigarette lighter.

6. Place steering wheel in lowest position.

7. Carefully pry around all edges of dash trimpanel to release six (6) metal retaining clips. Disconnect all wiring harnesses and work dash trimpanel over steering column to remove panel.

8. Remove three (3) 7mm screws securing **factory radio**. Pull out radio, disconnect and remove.

SAFETY CHECK

✓ Return gear shift to park position.



1-800-955-9094
Technical Service

CRUTCHFIELD
CRUTCHFIELD.COM

Copyright 2006 Crutchfield Corporation